

PIATTO-solar

Datasheet



Just like other solar luminaires, the PIATTO solar is a stand-alone luminaire. Thanks to the built-in battery pack, the PIATTO solar can be used anywhere. The fixture is equipped with a PV panel in combination with a state of the art built-in control electronics and energy storage. The Timberlab solar luminaires are all about sustainability.



timberlab
natural outdoor solutions



SPECIFICATIONS

- **Wood species:** Chestnut
- **Dimensions:** 180 - 200mm
- **IP grade:** IP54
- **Power per LED module:** 1 Watt max.
- **Lumen output per LED module:** Lumen output varies depending on season and weather.
- **Beam angle:** 105x50°
- **Colour fixture:** RAL 7016
- **Lifespan:** Every type of wood has its own durability class. More information can be found at "Wood species" & "Sustainability". The LED module has an expected lifespan of 108.000 hours.
- **Photometric data:** Available on request.

OPTIONS

- **Certification:** PEFC
- **Post support:** The PIATTO-solar is available with an anti-theft solution which makes it more difficult to remove the luminaire.
- **Colour temperature:** Available in 2.700K, 4.000K and Amber (593nm).
- **Sensor:** The luminaire can be fitted with a built-in PIR sensor. The LED will illuminate at 10% after switching on. When motion is detected, the LED will switch temporarily (5min) to the maximum light output.
- **Variations :** All Timberlab products are unique. In addition to our standard options, we offer customization. Think of adding logos, sockets or different dimensions.



Only products indicated with the FSC® claim are FSC certified and come with our FSC-certificate number NC-COC-029615-KE. Only products indicated with the PEFC™ claim are 100% PEFC certified and come with our PEFC-certificate number NC-PEFC/COC-029615-FJ.

LED MODULES

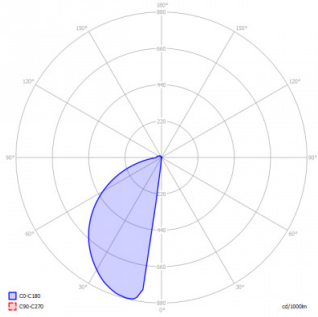
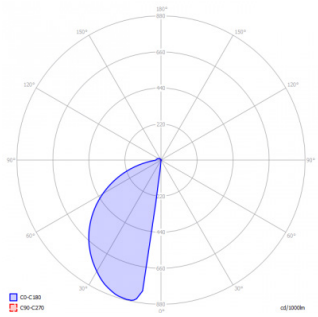
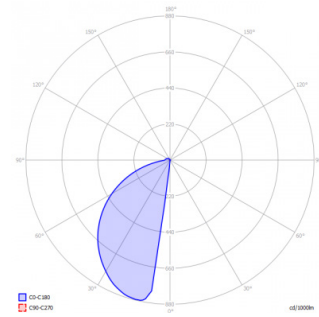
			
	TBL wall module 2.700K	TBL wall module 4.000K	TBL wall module AMBER 593 nm
Voltage	n.a.	n.a.	n.a.
Power	1W	1W	1W
Power factor	0.39*	0.39*	0.37*
Lumen output	20 lm	29 lm	10 lm
Efficiency	20 lm/W*	29 lm/W*	10 lm/W*
Colour temp.	Warm White 2700K 2683K*	Cool White 4000K 3981K*	AMBER x=0.5853 y=0.4043*
CRI	84*	72*	n.a.
Dimmable	on request	on request	on request
Label	B	B	B
IP grade	IP 54	IP 54	IP 54
Beam angle	105x50*	105x50*	105x50*
Number of LEDs	2	2	2
Temperature range in operation	-20...+50°C	-20...+50°C	-20...+50°C
Lifespan	100.000 h	100.000 h	100.000 h
* Measured values			



DIMENSIONS AND WEIGHT

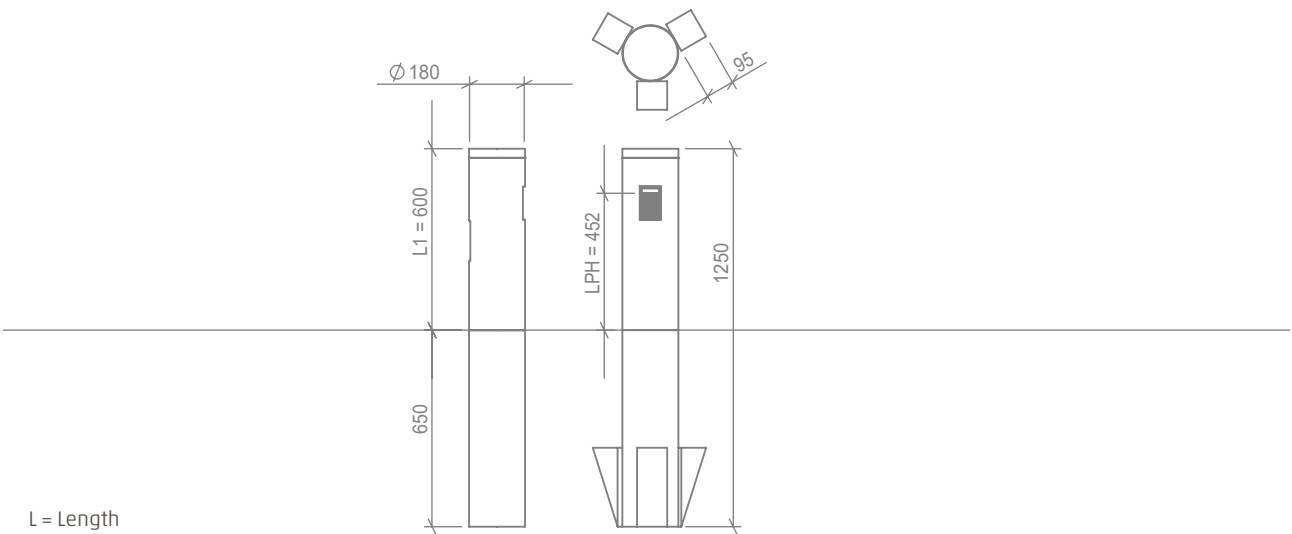

Weight chestnut	20 kg
C02 storage chestnut	32 kg

PRODUCT CODE GENERATOR

Product family	Wood species	Certification	In ground / post support	Colour temp.	Type	Voltage	Variations
XX	X	X	XX	X	X	X	XX
23= PIAT-TO-solar	2= Chestnut	0= N.a. 2= PEFC	00= Length 1 + 600mm in ground	1= 2.700K 3= 4.000K 4= Amber	0= Without PIR 1= With PIR 2= Without PIR with anti-theft 3= With PIR with anti-theft	0	00

EXAMPLE

PIATTO-solar, Chestnut, PEFC, Length 1 + 600mm in ground, 2.700K, Without PIR
Product code: 2322001000