

POST HOLDERS

To mount the Timberlab products on, for example, a deck, concrete foundation, tile or roof terrace, an extensive range of post holders and foundation elements is available to choose from. Above-ground mounting also has a positive effect on the lifespan of the Timberlab products.

PH02

Post holder 100 with flange
Models: EYE 100, PERI 100 & TORRE 100
Material: Stainless steel 316
Weight: 3 kg

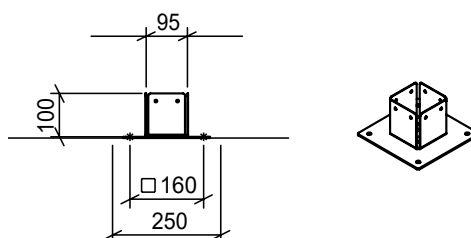

PH03

Post holder 100 with spike
Models: EYE 100, PERI 100 & TORRE 100
Material: Stainless steel 316
Weight: 2 kg

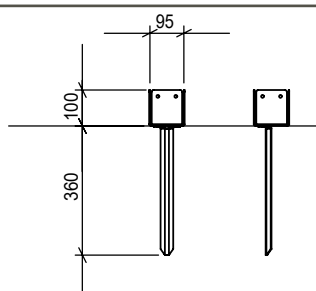



Post holder PH03

PH05

Post holder 150 with flange
 Models: EYE 150, EYE SOLAR, PERI 150,
 TORRE 150, TORRE SOLAR & FARO
 Material: Stainless steel 316
 Weight: 4 kg

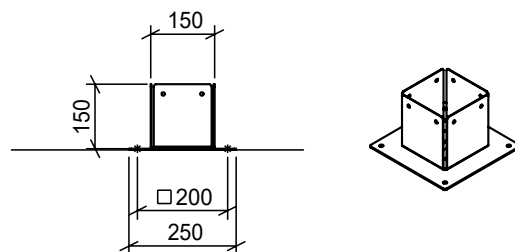

PH06

Post holder (per 3)
 Models: BOSCO, BOSCO SOLAR, PIATTO, BASSO & SOTTO
 Material: Stainless steel 316
 Weight: 2 kg

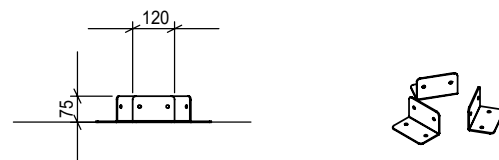

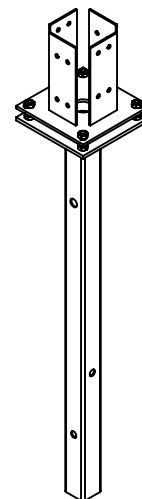
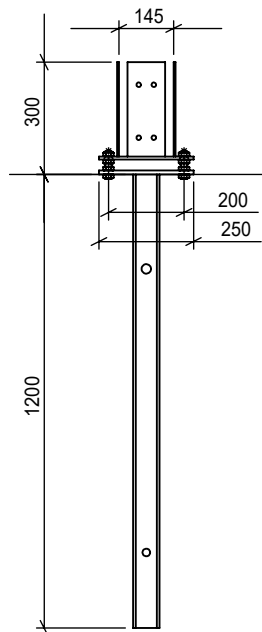
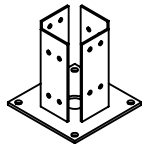
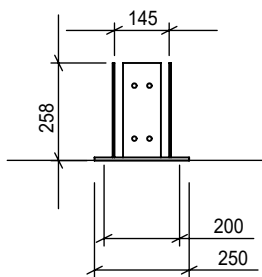

PH07

Post holder lamp post

Models: STRATO, STELLE, ANGELO & PILA

Material: Galvanised steel

Weight: 7 kg

PH08

Post holder

Models: STRATO, STELLE, ANGELO & PILA

Material: Galvanised steel

Weight: 20 kg

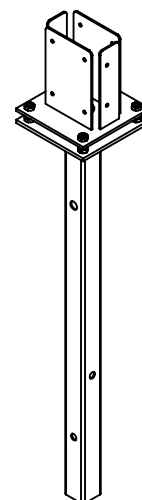
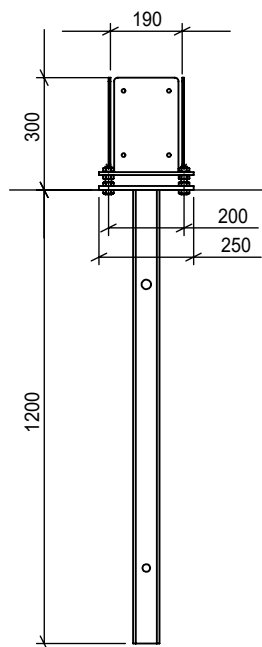
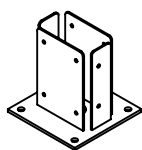
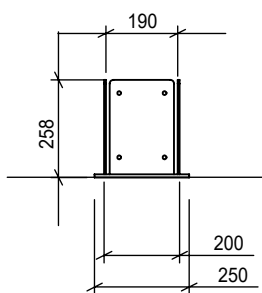

PH09

Post holder RIPARO

Models: RIPARO

Material: Stainless steel 316

Weight: 7 kg

PH10

Post holder RIPARO

Models: RIPARO

Material: Stainless steel 316

Weight: 20 kg